

COMMENTS

Your input matters—add your thoughts on the sticky notes below.

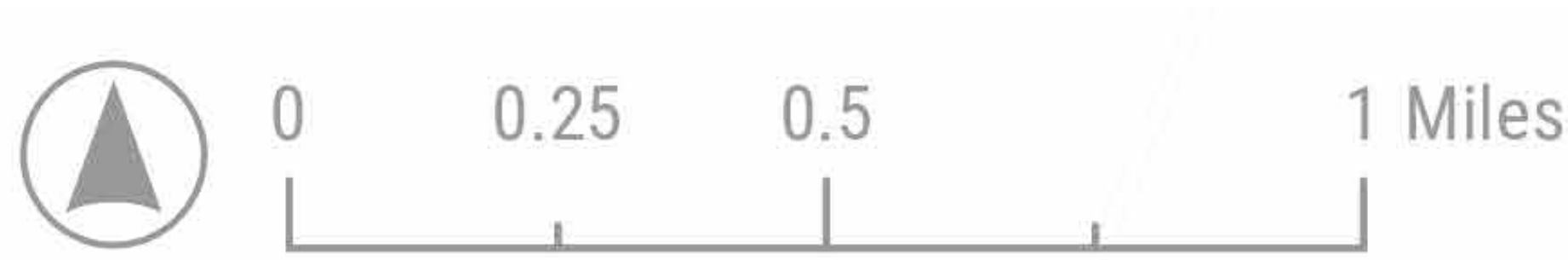

- LEGEND**
- Study Boundary
 - County
 - Parks
 - Waterbodies
 - Parks Trails/Shared Use Path

- Potential Open Space and Green Network**
- Green Easement Corridor
 - Utility Easement Line
 - Potential Parks



Source: GIS Open Data Portal, Planning Department of Prince George's County, Maryland



SUBREGION 01 | CONNECTIVITY NETWORK



COMMENTS

Your input matters—add your thoughts on the sticky notes below.

Green Easement Corridor

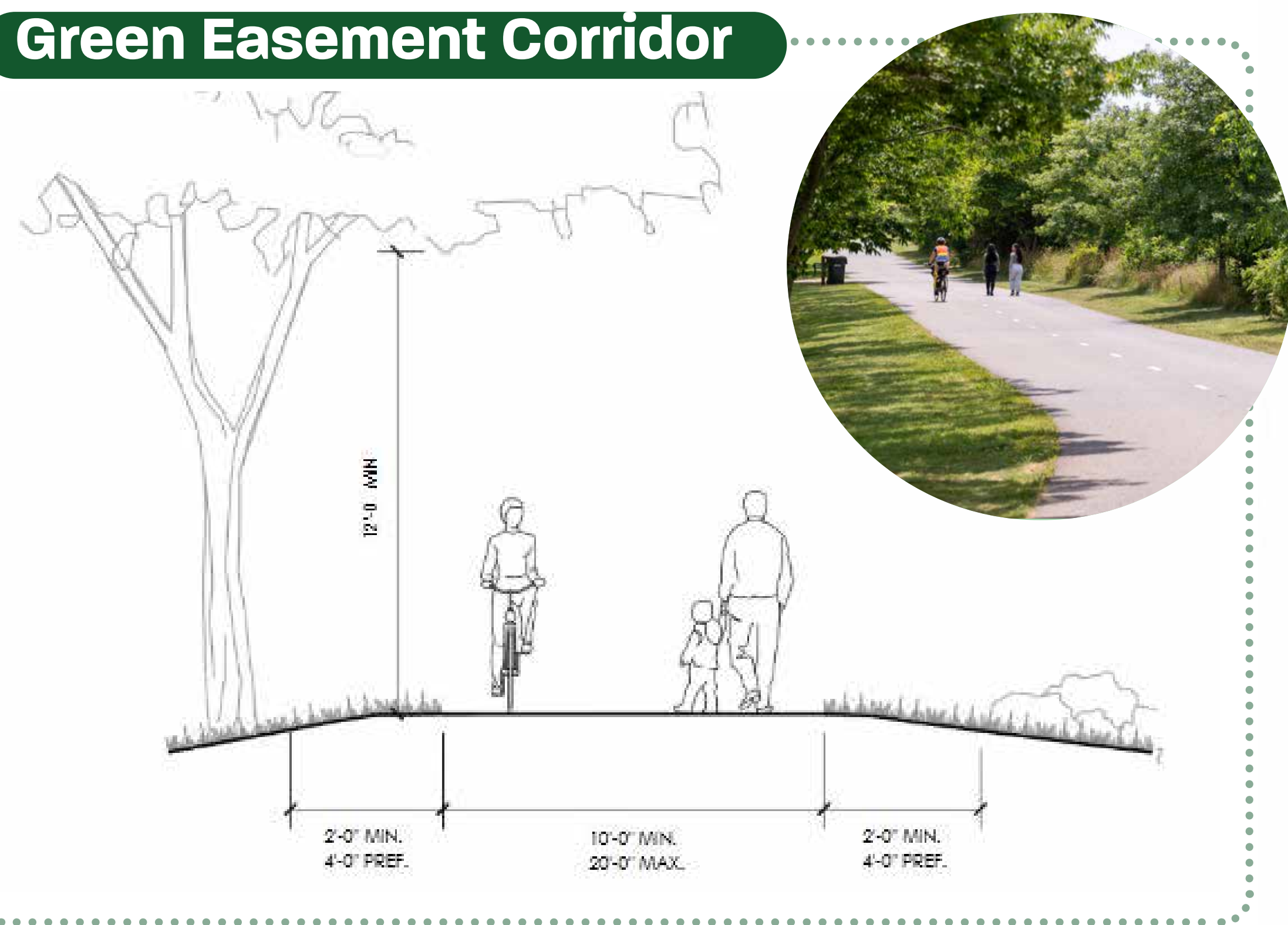

Shared Use Path

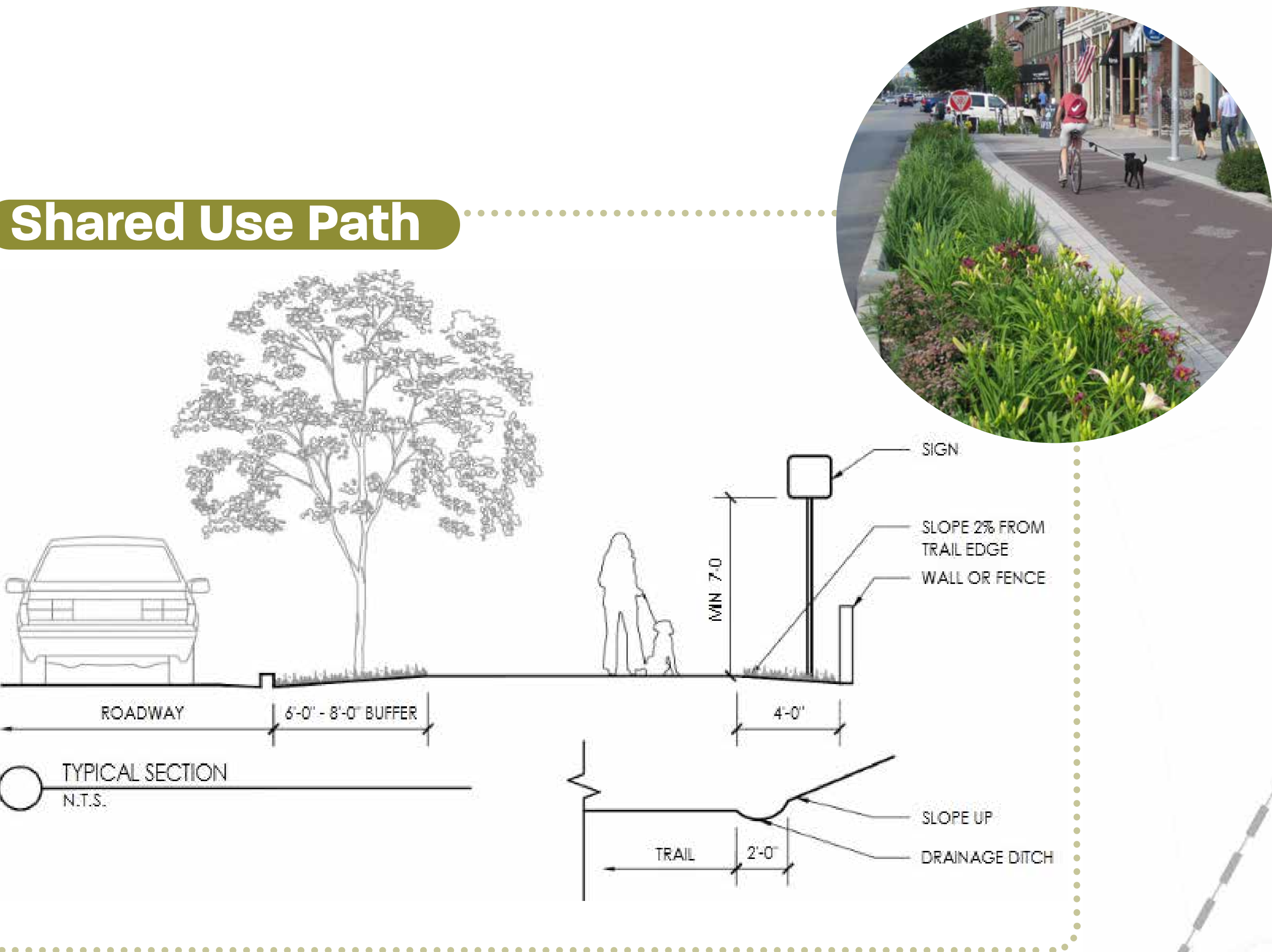

Shared Street

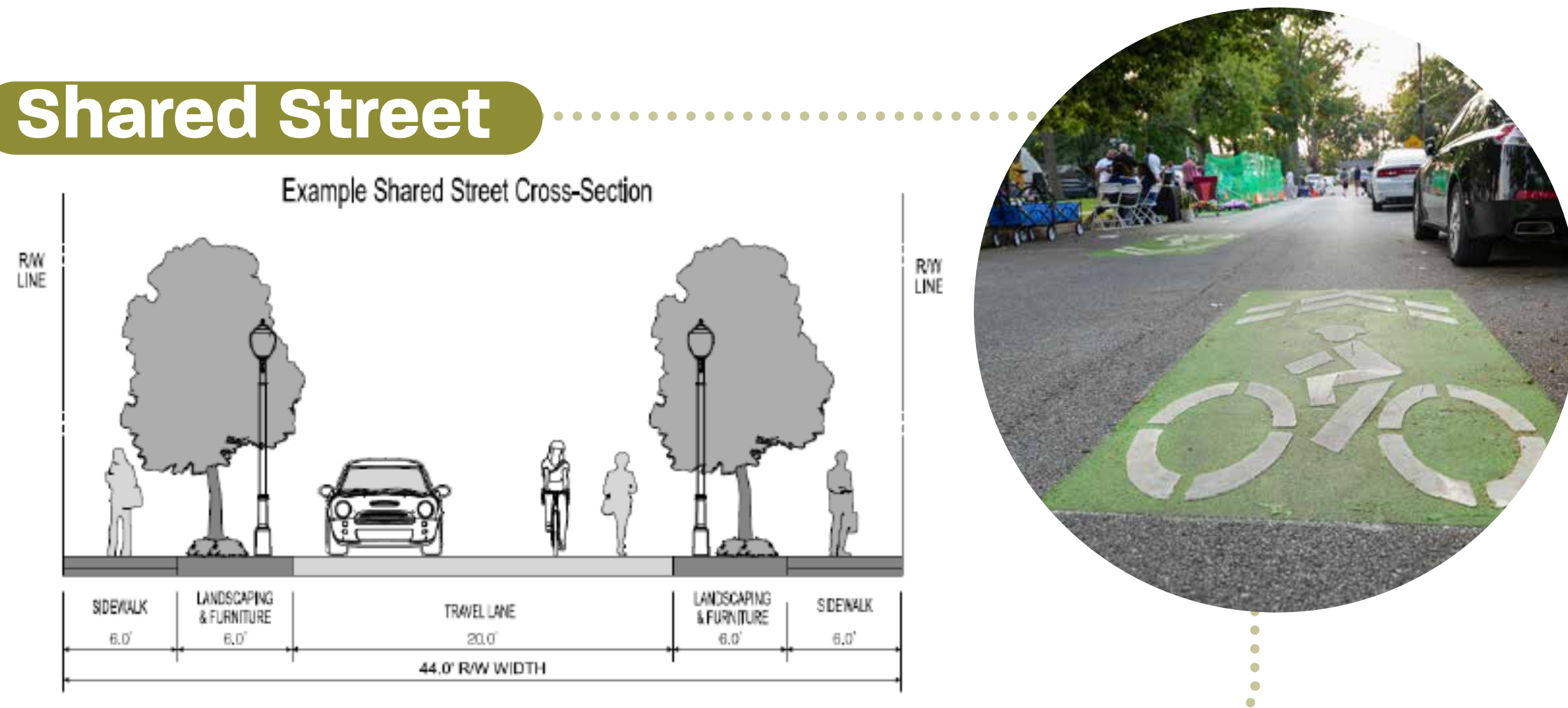

LEGEND

- Study Boundary
- County
- Parks
- Waterbodies
- Freeway
- Arterial
- Major Collector
- Collector
- Mixed Use Boulevard
- Industrial
- Other
- Parks Trails/Shared Use Path
- National Trail Network-Washington-Rochambeau
- Planned
- Planned (alignment to be determined)

- Potential Connections
- Green Easement Corridor
- Shared Street/ Shared Use Path
- Mixed Use Boulevard



Source: GIS Open Data Portal, Planning Department of Prince George's County, Maryland

Mixed Use Boulevard

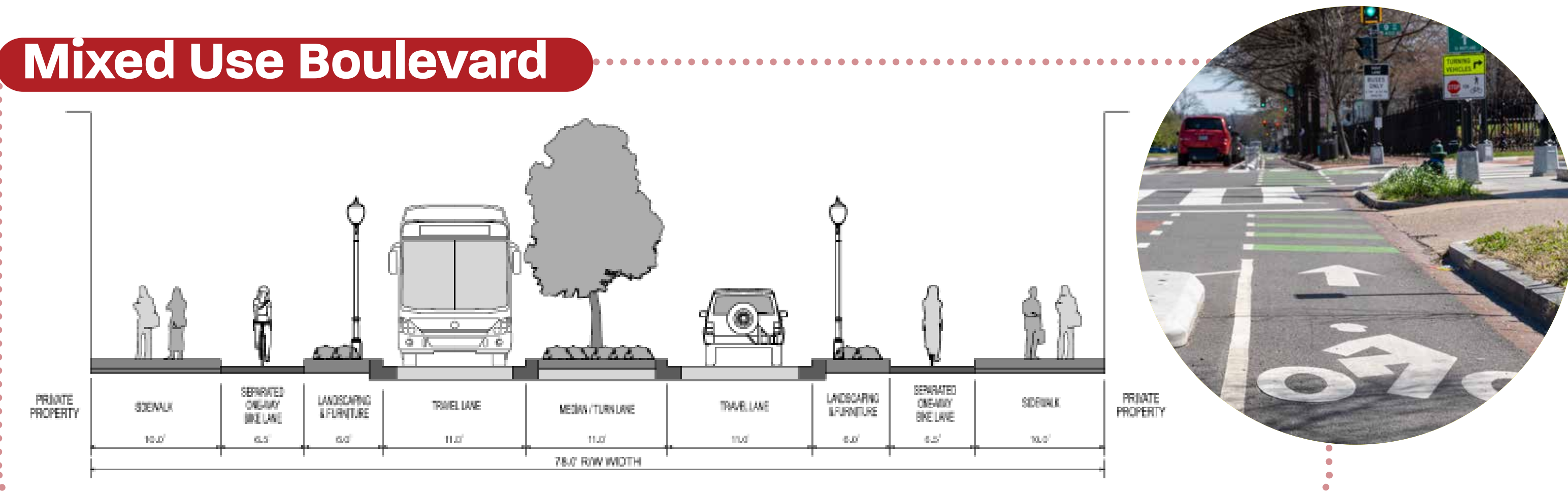

Mixed Use Boulevard

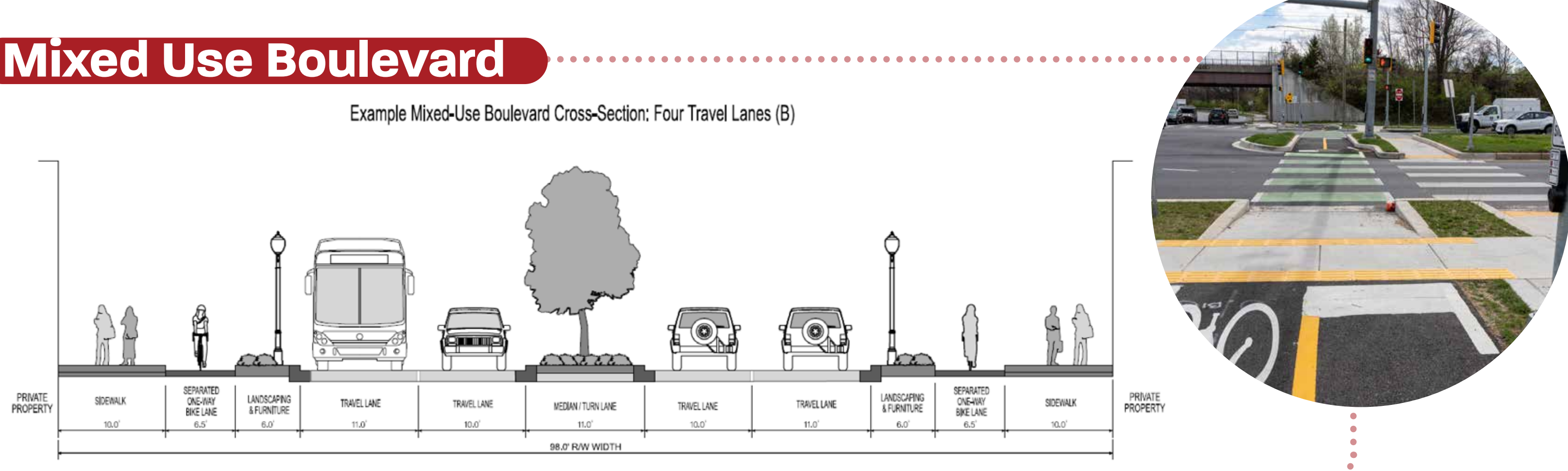

SUBREGION 01 | PLACEMAKING & CULTURAL IDENTITY

COMMENTS

Your input matters—add your thoughts on the sticky notes below.

“Placemaking is an approach to planning and design that creates vibrant, inclusive public spaces rooted in community identity. It focuses on the social and emotional connections people have with a place, shaping destinations where people gather and bring life to the space.”

Placemaking Elements



Art Installation



Wayfinding/ Signage

Local Identity



Local Architecture/ Historic Preservation

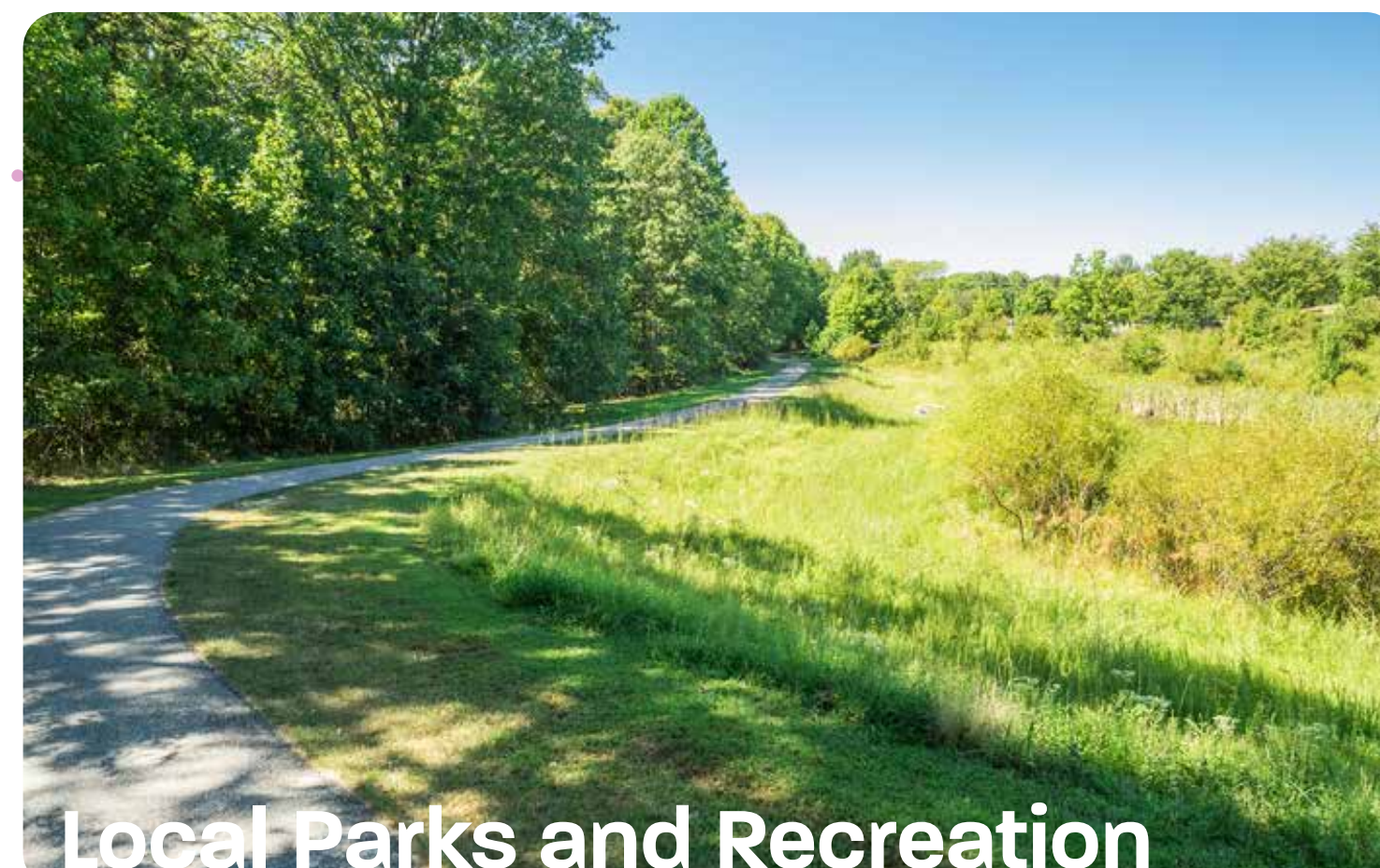

Local Parks and Recreation

Community-oriented Programs & Activities



Recreation



Community Events



Community Garden



Pocket Parks & Activity Centers

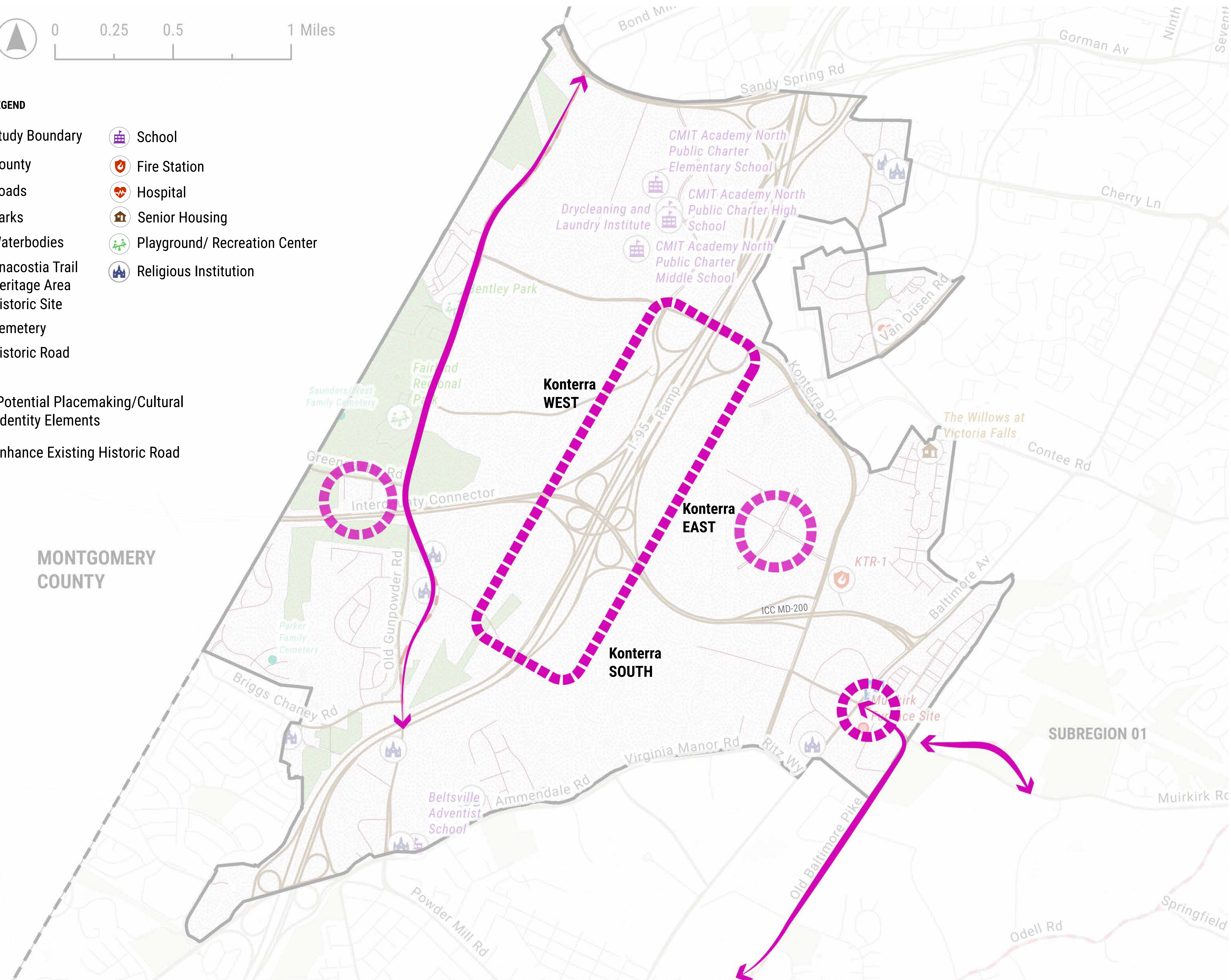
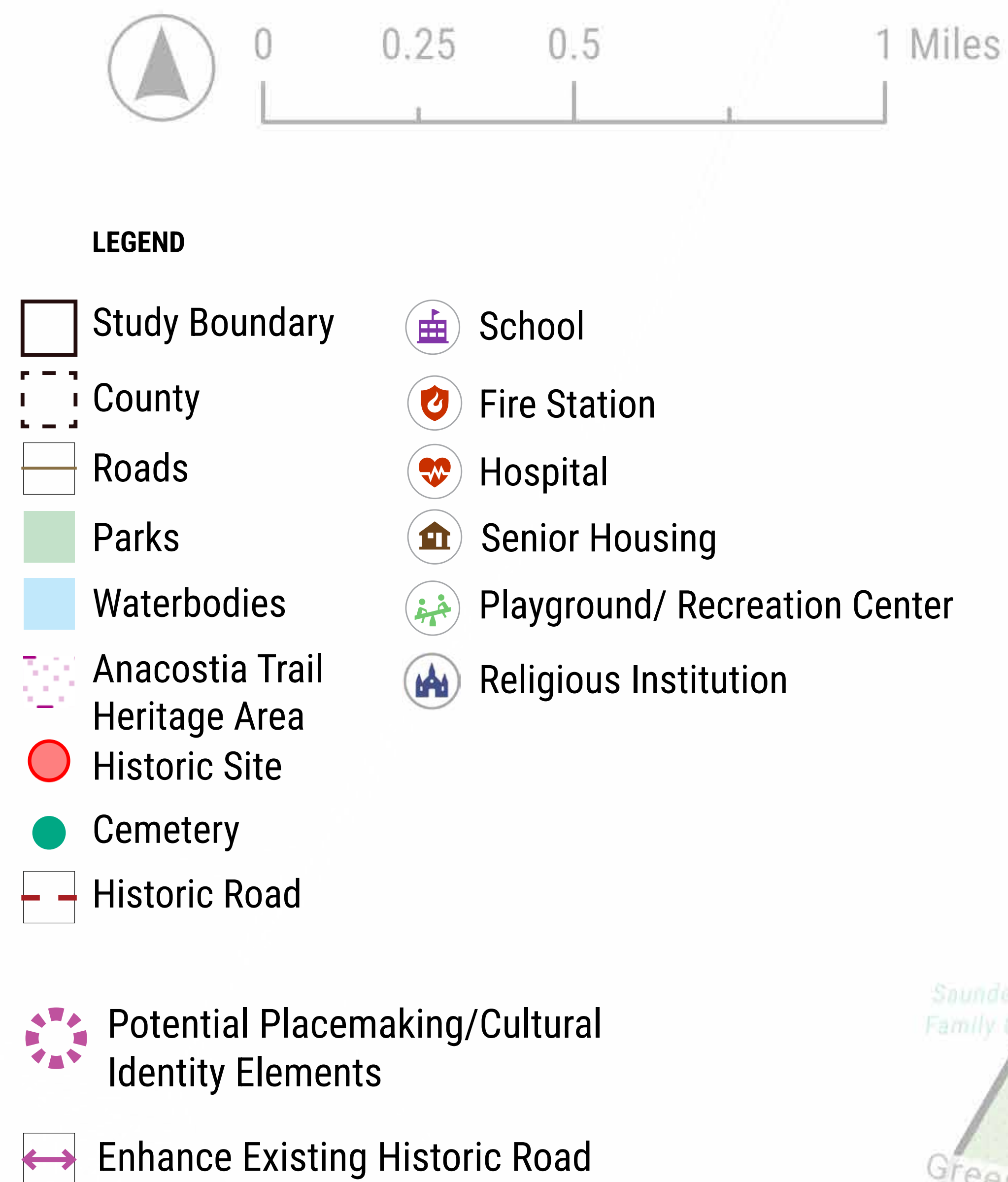

Source: GIS Open Data Portal, Planning Department of Prince George's County, Maryland

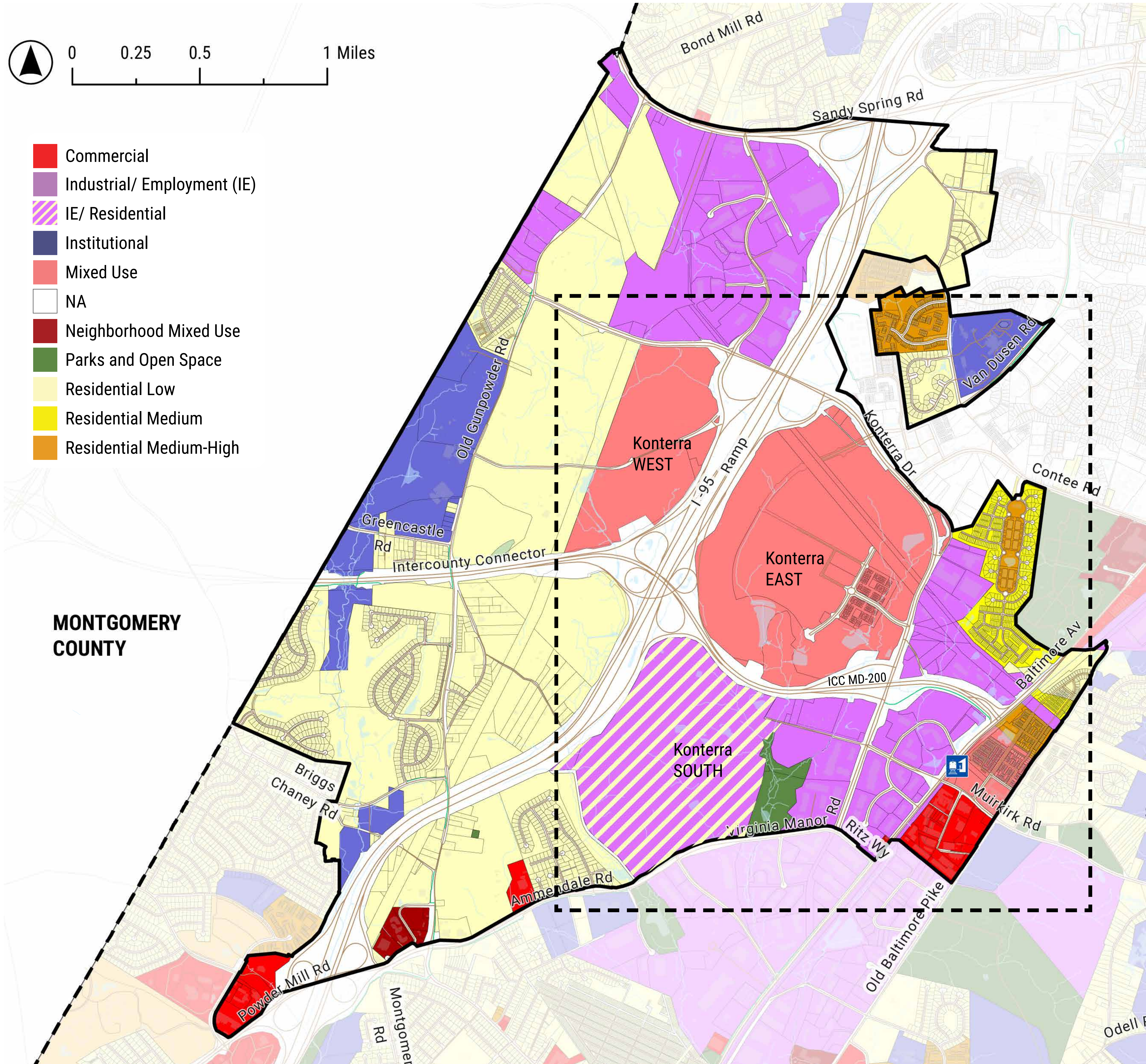
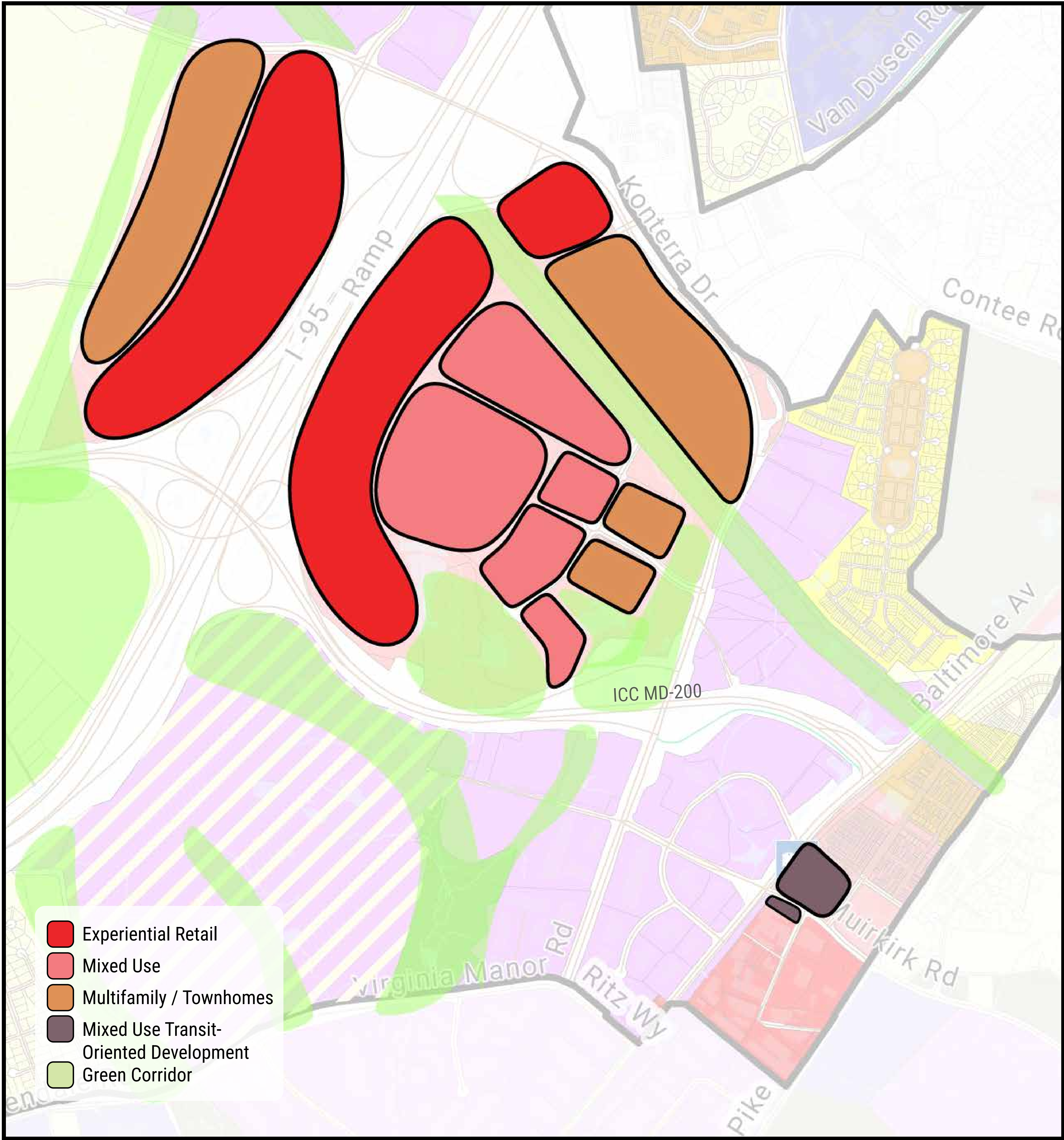

Source: GIS Open Data Portal, Planning Department of Prince George's County, Maryland

COMMENTS
Your input matters—add your thoughts on the sticky notes below.

